



European Union
European Regional
Development Fund



Pedestrianization policy for the Baia Mare City Center

Gergely TÖRÖK
Project manager

November 26th, 2019 | BRUSSELS

Baia Mare, the largest city in Maramureş county, one of the most picturesque areas in Northern Romania

The **city** is a symbol of a multi-cultural identity and multi-ethnicity, with various ethnic groups - Hungarian, Romanian and Saxon - living together in harmony

Pedestrianization of Liberty Square

LEGENDA:

- Obiectiv studiat
- Cladiri existente
- Umbrele propuse
- Pavaj propus 1 (30x60cm)
- Pavaj propus 2 (30x60cm)
- Rigola tasnitori
- Placa metalica - bronz
- Tasnitori
- Copaci noi propusi
- Copaci existenti ce se pastreaza
- Copaci propusi - greenbox
- Corpuri de iluminat - strada
- Corpuri de iluminat - piata
- Accese pietonale existente
- Accese auto existente
- Banci propuse (piatra)
- Banci propuse (lemn)

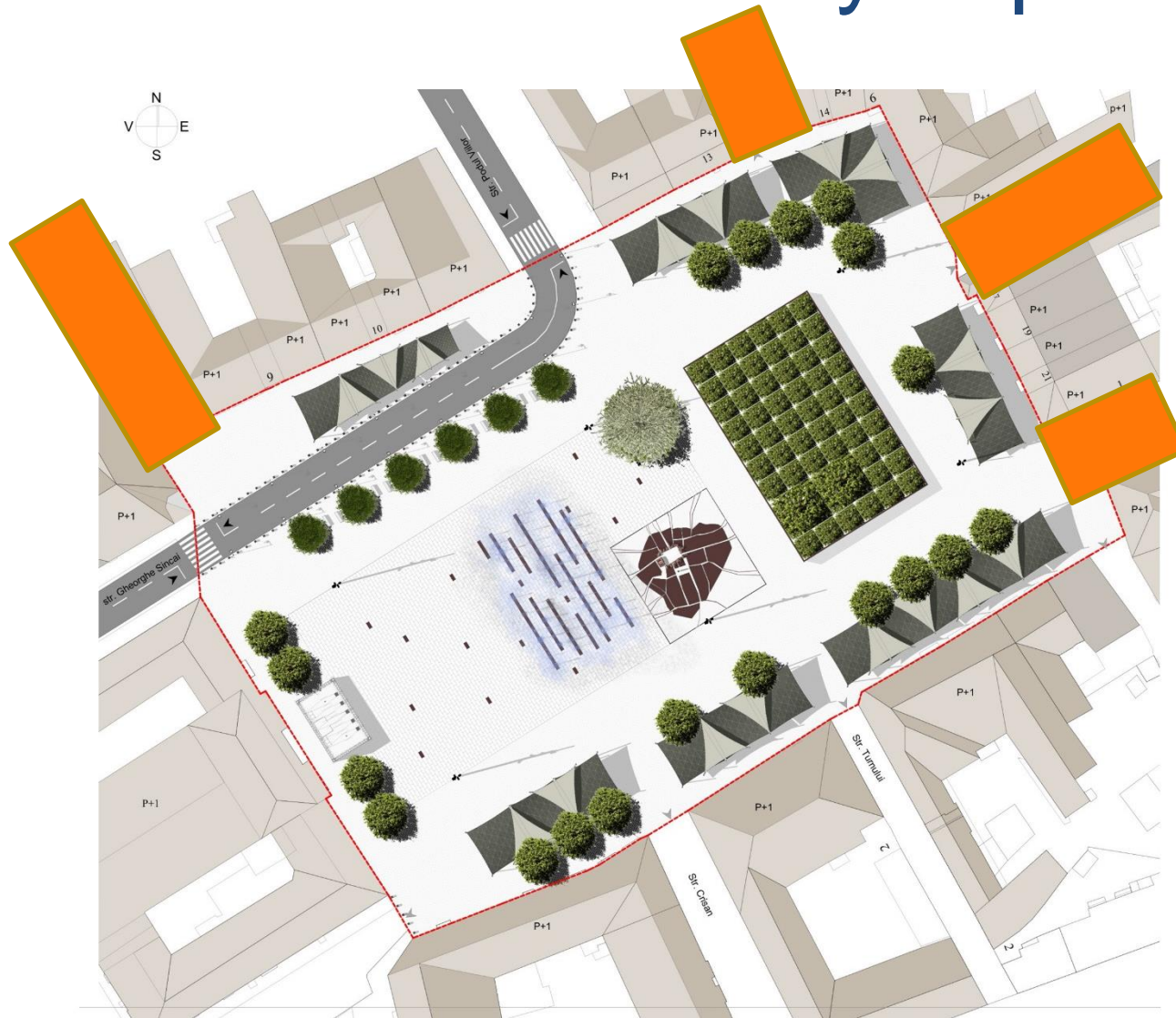

1st stage:

- pedestrianization of Liberty Square
- closing down 4 adjacent streets
- rehabilitation of historic buildings
- PHARE pre accession funds

Fortress Square and Stephen's Tower

2nd stage:

- **Stephen's Tower** within the **Fortress Square** is the emblem of **Baia Mare**, but citizens and tourists were attracted more by the rehabilitated central part of Baia Mare
- **goal** was to transform the square into a place where **history blends** with everyday life of Baia Mare

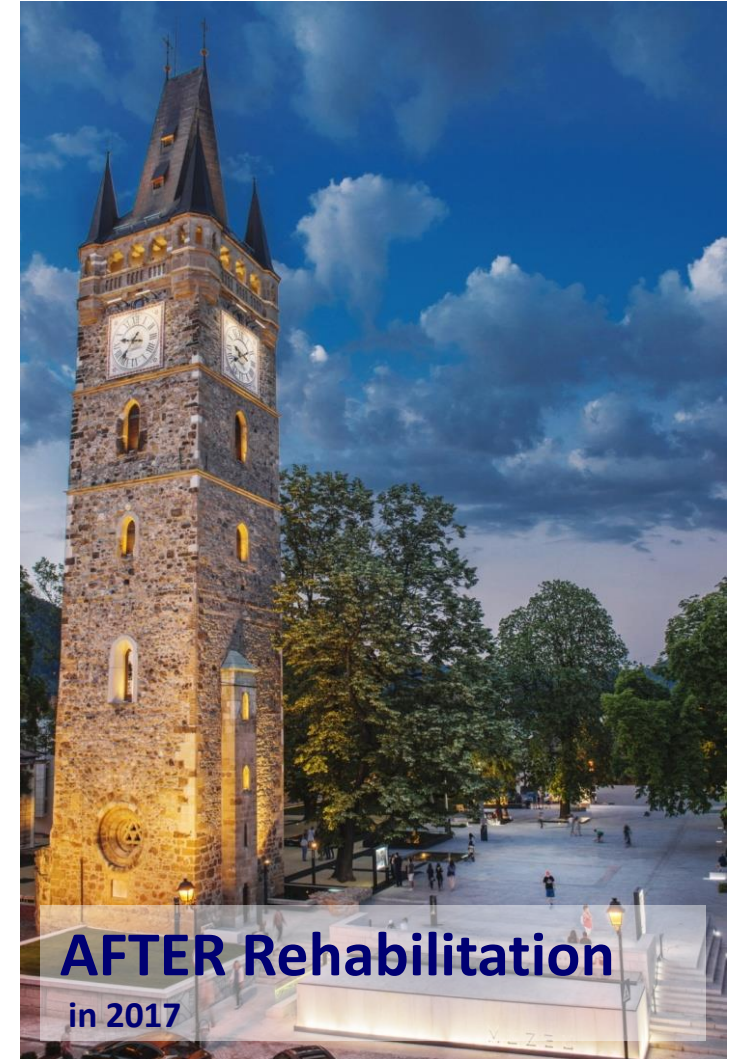

Remodeling Liberty Square

3rd stage:

- remodeling the main square and making it part of the pedestrian corridors crossing the city
- reclaiming more streets for pedestrians in the central area



Evidence of success

- historical centre attractive for both locals and tourists
- attractive design, both public spaces winning multiple awards (the Fortress Square was even nominated for the European Public Space Award – CCCB) → welcoming and pedestrian friendly city.
- increased the number of tourists (17% between 2007 and 2017)
- increased number of various shops and restaurants that opened in the centre
- pedestrianization policy integrated into the SUMP and continues with the regeneration of other public spaces (ex. Unirii and Revoluției squares) and the pedestrianisation of surrounding streets.



Thank you!

