



# LCA4Regions

Interreg Europe



European Union  
European Regional  
Development Fund

## RAB and Good practices Lodzkie Region

1st Thematic Learning Journey  
15-16 January 2020 Lithuania

# LODZKIE REGION - POLAND





## REGION SPECIFICATION

### ➤ favorable location

- the region is located in the middle of the country
- close to the capital (120 km)
- with very good communication infrastructure (highways, airport, speed trains)

### ➤ industrial and agricultural nature of the region with the growing role of services

- well developed compared to the rest of the country (5th place in terms of investment attractiveness)
- but on average at EU level (it does not reach 75% of EU development level)

### ➤ leading industries (by employment):

- light industry (historical determinant of the region),
- electromechanical, electronic, food, chemical



## REGION SPECIFICATION

- **the region is developing in line with European trends** (digitization, urbanization, circular economy, environmental protection and efficient use of natural resources)
- **6 regional smart specializations (included in the strategic documents of regional development)**
  - Energetics
  - Modern textile and fashion industry
  - Medicine, pharmacy, cosmetics
  - Innovative agriculture and agri-food processing
  - Advanced building materials
  - IT and telecommunications
- **important academic and research center (18 public and private universities)**
  - University of Lodz (public)
  - Lodz University of Technology (public)
- **the region has great development potential**

# LCA PUBLIC INITIATIVES

- **development of the education system and capacity building for LCA**
  - Lodz University of Technology
    - ❑ 2017 - *LCA specialization in the commodity field of study*
    - ❑ 2019 - *optional LCA subject for students*
    - ❑ 2019 - *external training offer regarding LCA and environmental protection*
    - ❑ 2021 - *obligatory LCA subject for all students*
    - ❑ *postgraduate studies related to LCA "Environmental management in organization"*
    - ❑ *ongoing participation in LCA related research projects*
  - University of Lodz - *Eco City field of study (2018)*
- **participation of the regional authorities in international circular projects**  
*(INTERREG: GPP4Growth, Replace, DeCarb, Aquares, LCA4Regions, SCREEN – Horyzont 2020)*
- **pro-environmental co-financing from EU and national funds**
- **bioeconomy development in the region**
  - *promotion and various bioeconomy events: congresses, fairs, stakeholder meetings*
  - *BIOTECHNIKA company develops the production of bioethanol and biogas from waste obtained from sugar beet and potato processing*
- **obligatory waste segregation** in Lodz for all residents from 1/12/2019
- **numerous renewable energy initiatives** willingly taken by municipalities (photovoltaic panels, wind energy) although it is not the dominant source of energy in the region

# LAW AND STRATEGIC DOCUMENTS

- **over a dozen laws and other acts of national law relating to LCA including:**
  - Roadmap of Transformation Towards a Circular Economy - Resolution of the Council of Ministers
  - Public Procurement Law
  - Environmental Protection Law
  - Waste Law
  - Act on packaging management and packaging waste
- **9 national strategies with provisions for LCA including :**
  - Strategy for Innovation and Efficiency of the Economy "Dynamic Poland 2020"
  - Strategy for Sustainable Development of Poland up to 2025
  - National Strategy for Regional Development 2030
- **a few national operational programs in which a reference to the LCA has been included in the project selection criteria**
- **Polish equivalents of ISO standards related to LCA**
- **2 regional strategies, assumptions of ROP 2021-2027 and a waste management plan for the Lodzkie region, which contain references to LCA**
- **application of green public procurement criteria in the region for 19 purchasing groups**

# REGIONAL AGENTS/ EXPERTS

## General Remarks

- 9 advisory entities in the region but with little experience
- none of them perform LCA analyzes
- at least 6 identified expert entities in the neighboring region operating on a national scale (including 4 institutions performing LCA analyzes in Warsaw)
- central location of the Lodzkie region - a chance to use the services of experts from the neighboring region with the capital in Warsaw

# GOOD PRACTICES

## General Remarks

- **1 identified existing good practice in the region (EPD – construction industry)**
- **2 other identified practices are still being implemented (chemical industry)**
- **other practices are available but outside the region**
- **there is no national database of existing LCA applications or implementations**



# GOOD PRACTICE – ATLAS Company

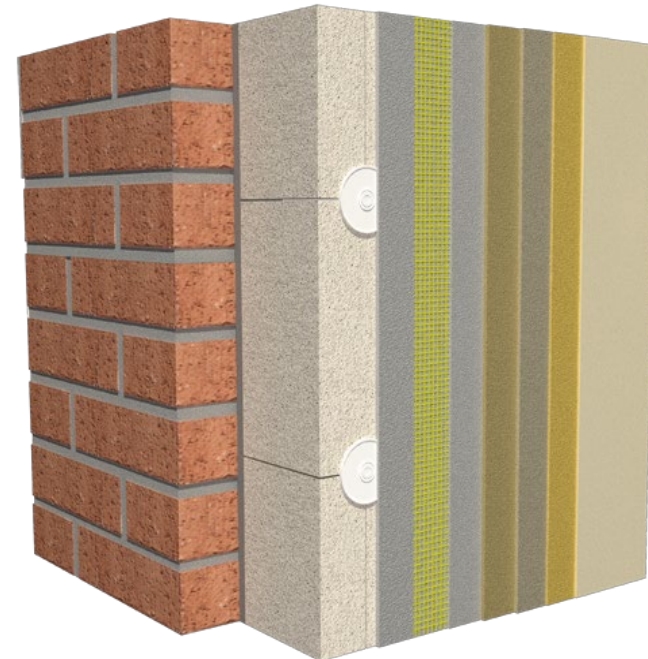

***thermal insulation systems***  
***(Environmental Product Declaration)***



# ATLAS Company

1. **ATLAS - currently the largest producer of construction chemistry products in Poland.**
2. **One of the first Polish companies which decided to assess environmental impacts using the LCA method.**
3. **The Environmental Product Declaration was developed for the first time in 2014.**
4. **The ATLAS ETICS thermal insulation system was adopted for analysis including products for insulating external walls of buildings using polystyrene.**
5. **In 2018, due to the ending period of 5 years of validity of the declaration, the company again began the LCA analysis.**
6. **In all cases, the calculations were carried out for the "cradle to gate" variant, covering the supply of raw materials, transport and manufacture of products.**
7. **The environmental declarations and the data contained therein were verified by the Building Research Institute in Warsaw which carried out the LCA analysis.**
8. **The process was successfully completed in March 2019 by issuing the current environmental statement.**
9. **Three people were involved on the ATLAS side: technical employee, coordinator and graphic designer.**
10. **The whole process lasted 9 months (including data collection 6 months).**

# CONCLUSIONS

## LCA CHALLENGES

- **young, not yet shaped LCA market in the region**
- **few experts with relevant experience in the region (more at the national level)**
- **few existing LCA implementations; more implementations are underway; it takes more time to evaluate the effects**
- **high costs of expert services and LC analyzes**
- **highly developed regions have easier access to LCA services**
- **no widely available national LCA supporting databases**
- **lack of a universal holistic approach to LCA in the national and the regional regulations**
- **slow pace of implementing changes in regulations (long legislative process)**

# CONCLUSIONS

## LCA OPPORTUNITIES

- **policy favoring the development of LCA at European, national and regional level**
- **growing interest and awareness of the society and entities**
- **information campaigns - more and more information in the media, activities of local authorities, events related to this issue**
- **region's participation in EU international projects on circular economy and LCA**
- **high development potential of the Lodzkie region and good access to LCA services**
- **well-developing LCA education system and green public procurement**
- **first LCA implementations (mainly in the construction industry)**
- **existing first records and gradual introduction of changes regarding LCA in national regulations and strategic documents**
- **increasing number of new advisory and expert companies dealing with LCA issues**



# LCA4Regions

Interreg Europe



European Union  
European Regional  
Development Fund

# Thank you!

**Lodzkie Region, Poland**

projekty.międzynarodowe@lodzkie.pl

tomasz.gasiorowski@lodzkie.pl

Questions welcome

[www.interregeurope.eu/LCA4Regions](http://www.interregeurope.eu/LCA4Regions)